

TPU Series

Polyurethane Tube

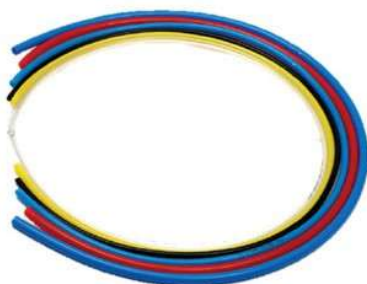

Features

- Excellent resistance to pressure, weather, and corrosion, along with flexibility
- Easy connection to airline fittings

Product Precautions

Please read the product manual before use and refer to the safety precautions and general warnings

⚠ Cautions

- It can be used with general industrial water. For other uses, please contact us in advance. Also, please ensure that surge pressure is kept below the maximum operating pressure. If the surge pressure exceeds the maximum operating pressure, it may cause fitting damage and tube rupture.
- When there is a temperature rise due to single extrusion, it may cause tube rupture.
- The minimum bending radius is specified based on the value at 20°C. At higher temperatures, the tube should be bent at a radius larger than the specified minimum bending radius.

How to Order

TPU0425 - C (200)

1 2 3

1 Model Name / Tube Description

- TPU : Polyurethane Tube
(See Table 2)

2 Tube Color

(See Table 1)

3 Length (per roll, meters)

| ①Series | | TPU0425 | TPU0604 | TPU0805 | TPU1065 | TPU1208 | TPU1611 |
|---------------------|-----------------------|---------|---------|---------|---------|---------|---------|
| ②Outer Diameter(mm) | | 4 | 6 | 8 | 10 | 12 | 16 |
| ③Inner Diameter(mm) | | 2.5 | 4 | 5 | 6.5 | 8 | 11 |
| ④Color | Green(G) | ○ | ○ | ○ | ○ | ○ | X |
| | Red(R) | ○ | ○ | ○ | ○ | ○ | X |
| | Black(B) | ○ | ○ | ○ | ○ | ○ | ○ |
| | Blue(BU) | ○ | ○ | ○ | ○ | ○ | ○ |
| | Yellow(Y) | ○ | ○ | ○ | ○ | ○ | X |
| | Orange(O) | ○ | ○ | ○ | ○ | ○ | X |
| | Transparent Blue(BUC) | ○ | ○ | ○ | ○ | ○ | X |
| | Transparent(C) | ○ | ○ | ○ | ○ | ○ | ○ |
| ⑤Length(M) | | 200M | 100M | | | 50M | |

*Table 1

Product Specifications

| | Polyurethane | Note |
|----------------------------|---|------|
| Hardness | 95A~98A | |
| Fluid | Air | |
| Maximum Operating Pressure | 7kgf/cm ² | |
| Operating Temperature | -20°C ~ 70°C | |
| Features | Excellent pressure resistance, weather resistance, corrosion resistance, and flexibility, making it easy to connect to airline fittings. | |
| Applications | Industrial automation, pneumatic tools, orchard and fluid transfer, vacuum straws, protective cover for metal and electronic products, etc. | |

*Table 2

Appearance and Dimensions

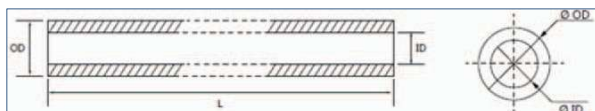

| Series | Outer Diameter (OD) | Inner Diameter (ID) | Length (L) | Minimum Bending Radius (mm) (based on 20°C) | Minimum Operating Pressure (kgf/cm ²) (based on 20°C) | Note |
|---------|---------------------|---------------------|------------|---|---|------|
| TPU0425 | 4mm | 2.5mm | 200m | 10mm | 0-10 | |
| TPU0604 | 6mm | 4mm | 100m | 15mm | 0-10 | |
| TPU0805 | 8mm | 5mm | 100m | 20mm | 0-10 | |
| TPU1065 | 10mm | 6.5mm | 100m | 30mm | 0-10 | |
| TPU1208 | 12mm | 8mm | 100m | 35mm | 0-10 | |
| TPU1611 | 16mm | 11mm | 50m | 65mm | 0-10 | |

*Table 3