

SP Series

Speed controller with built-in one touch fitting

Fitting/Speed controller
(Piping accessories)

SP Series



How to Order

SP **2** **2** **0** **1F** – **02** – **08** **S** **W**

1 2 3 4 5 6 7 8

1 Body size

1 : M5
2 : R 1/8, 1/4
3 : R 3/8
4 : R 1/2

2 Type

0 : Union
2 : Elbow

3 Control type

0 : Meter – Out
1 : Meter – In

4 Built-in one touch fitting

5 Thread

M5 : M5 X 0.8
01 : R(c) 1/8
02 : R(c) 1/4
03 : R(c) 3/8
04 : R(c) 1/2

6 Applicable tubing O.D.

04 : Ø4
06 : Ø6
08 : Ø8
10 : Ø10
12 : Ø12

7 Thread seal method

S : Sealant

8 Flat-blade screw driver Type

Blak : Standard
D : Driver

Specifications

Fluid	Pressed Air
Operating pressure range	0~150psi (0~9.9kgf/cm ²)
Fluid temperature	0~60℃
Applicable tube	Polyurethane tube, Nylon tube

SPC Series

Speed Controller with built-in pilot check valve

Fitting/Speed controller
(Piping accessories)

SPC Series



How to Order

SPC **06** **W**

1 2 3

1 Series

2 Body Size

06 : Ø6
08 : Ø8
10 : Ø10
12 : Ø12

3 Thread

01 : R(c) 1/8
02 : R(c) 1/4
03 : R(c) 3/8
04 : R(c) 1/2

Specifications

Fluid	Air(No other type of gas or liquids)
Operating pressure range	1 ~ 9.9 kgf/cm ² (100~990KPa)
Negative Pressure(Vaccum)	– 750mmHg(–750 Torr, –100Kpa)
Fluid temperature	0 ~ 60℃

Pilot Check Valves **SPC Series**

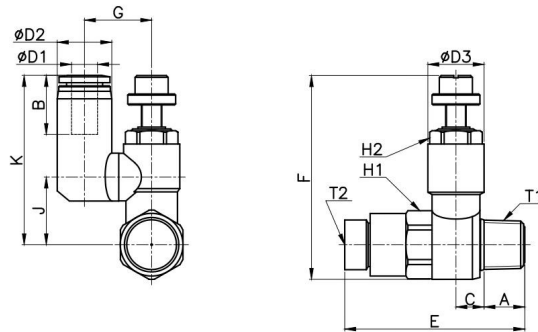

METRIC-BSPT(R)

Unit: mm

MODEL	ØD	A	T1	T2	B	ØD1	ØD2	ØD3	C	E	F		G	J	K	H1 (Hex)	H2 (Hex)	Weight (g)
SPC06-01	6	8.0	R 1/8	M5	17.0	6.0	12.6	12.1	8.0	35.4	43.6	48.4	16.1	14.9	38.9	12	10	30.4
SPC06-02		10.5	R 1/4	R 1/8		6.0	12.6	15.4	7.6	42.0	55.4	60.4	19.4	18.4	44.3	17	13	63.5
SPC08-01	8	8.0	R 1/8	M5	19.1	8.0	14.9	12.1	8.0	35.4	43.6	48.4	17.3	14.9	39.8	12	10	33.6
SPC08-02		10.5	R 1/4	R 1/8		8.0	14.9	15.4	7.6	42.0	55.4	60.4	18.4	18.4	46.7	17	13	66.3
SPC08-03		11.4	R 3/8	R 1/8		8.0	15.1	20.3	9.6	49.7	58.4	63.4	23.4	21.4	50.7	19	17	101.3
SPC10-03	10	11.4	R 3/8	R 1/8	20.2	10.0	17.6	20.3	9.6	49.7	58.4	63.4	23.4	21.4	53.0	19	17	105.2
SPC10-04		14.4	R 1/2	R 1/4		10.0	17.6	27.3	12.8	59.8	72.0	78.0	26.4	31.3	64.4	24	23	203.3
SPC12-03	12	11.4	R 3/8	R 1/8	22.7	12.0	20.6	20.3	9.6	49.7	58.4	63.4	23.4	21.4	54.8	19	17	110.0
SPC12-04		14.4	R 1/2	R 1/4		12.0	20.6	27.3	12.8	59.8	72.0	78.0	26.4	31.3	67.2	24	23	235.0

SPC Flow Graph

SPC 06-01
08-01

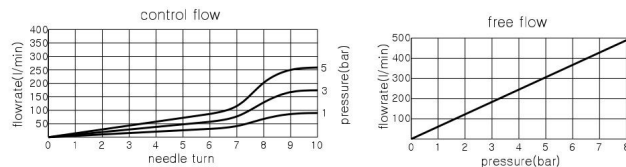

SPC 06-02
08-02

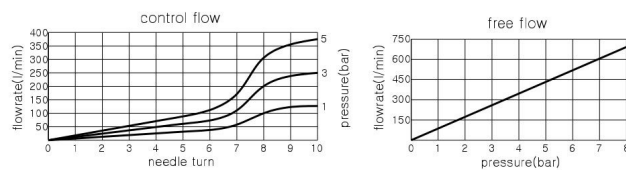

SPC 08-03
10-03
12-03

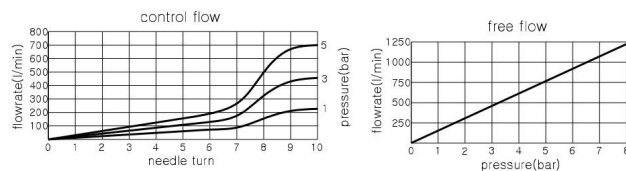

SPC 10-04
12-04

