

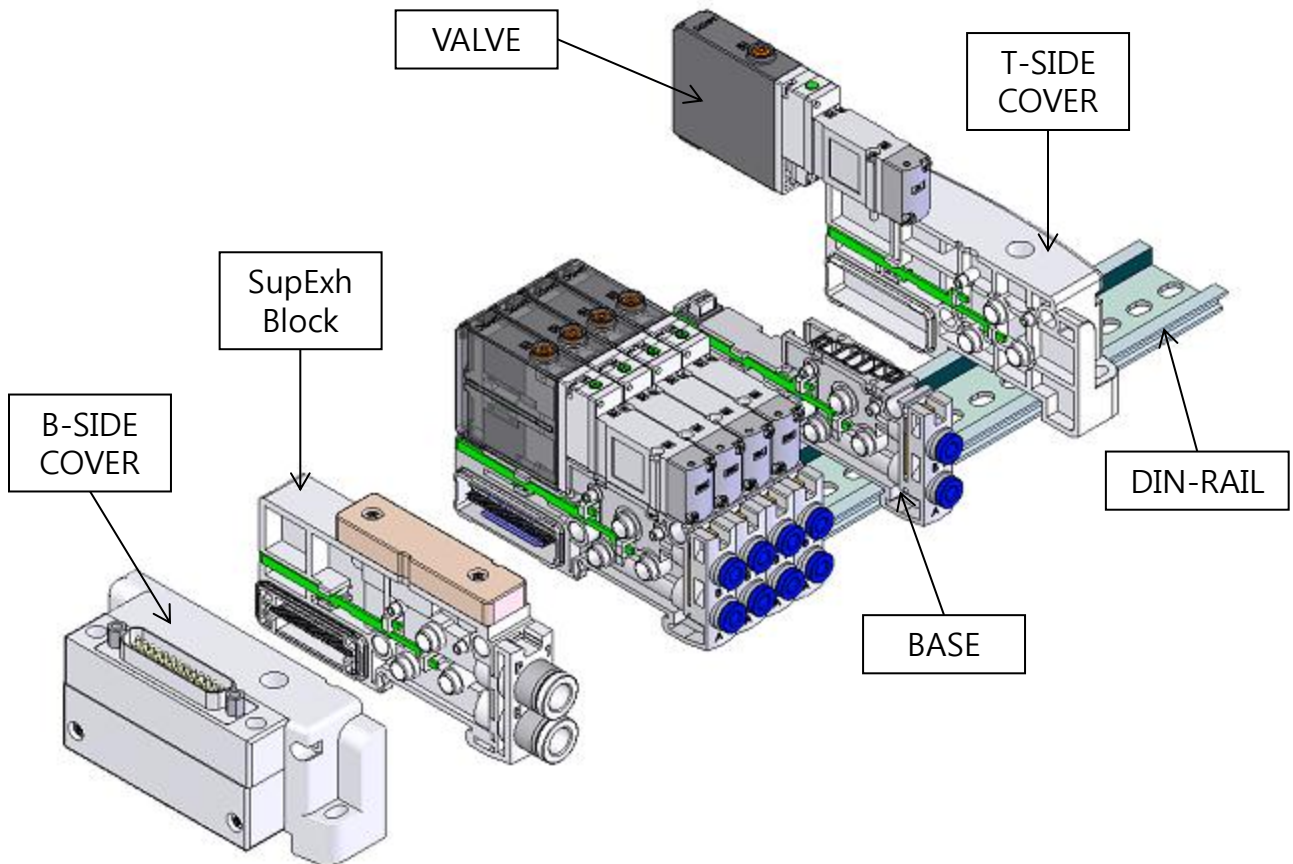

RS Valve Structure (Din Connector)



■ Structure of RS VALVE

⇒ B-SIDE COVER, SUP/EXH BLOCK, BASE, VALVE, T-SIDE COVER, and DIN-RAIL

■ Depends on options

⇒ Flat cable can be chosen instead of din connector.

⇒ Tie rod can be chosen instead of din rail.



RS Valve Structure (SI-Unit)

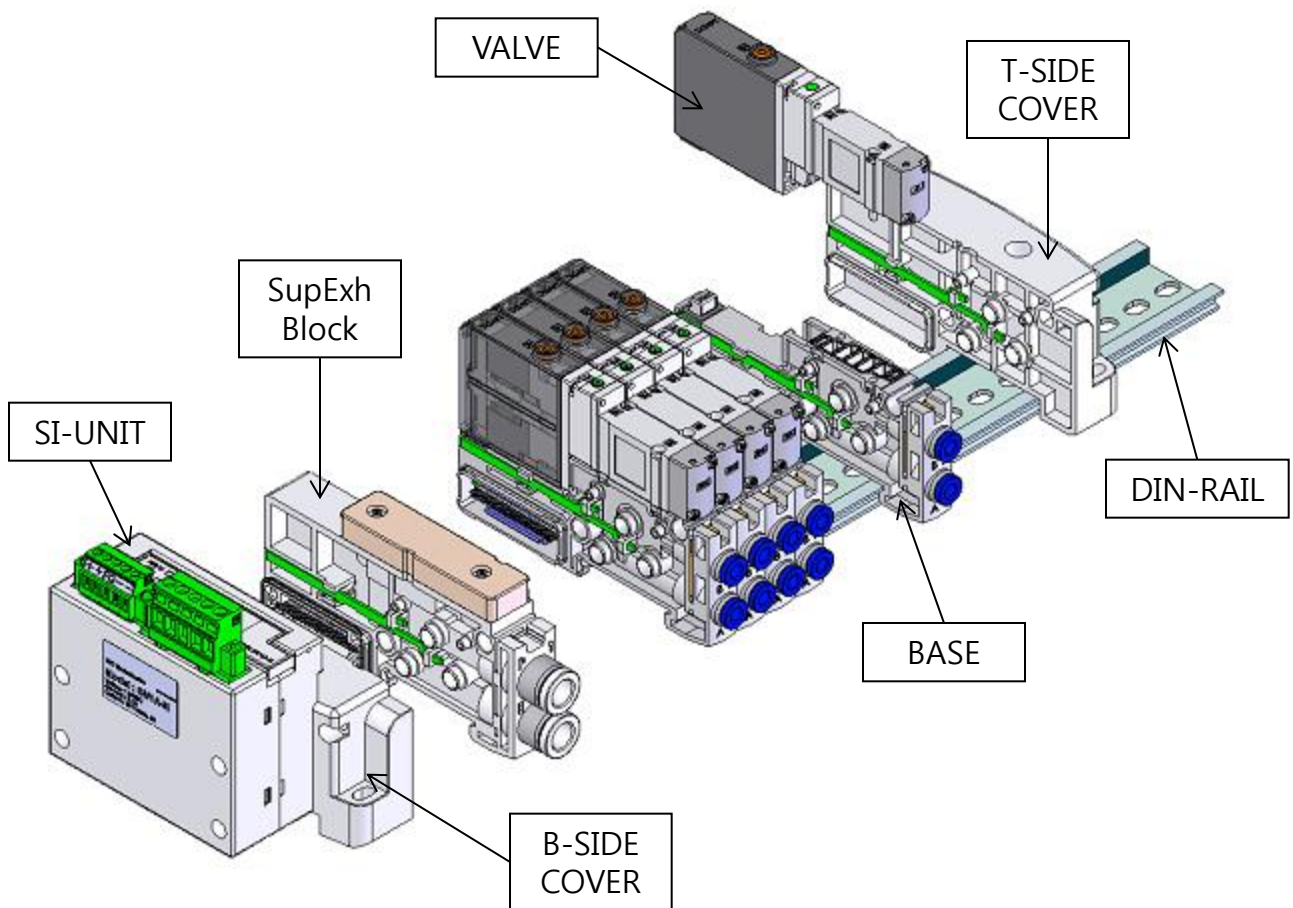

- Structure of RS VALVE
 - ⇒ B-SIDE COVER, SUP/EXH BLOCK, BASE, VALVE, T-SIDE COVER, and DIN-RAIL
- Depends on options
 - ⇒ Tie rod can be chosen instead of din rail.
 - ⇒ SI-unit can be attached to B-SIDE COVER

How to Disassemble Valve

- First, remove two screws on a valve body by using a screw driver

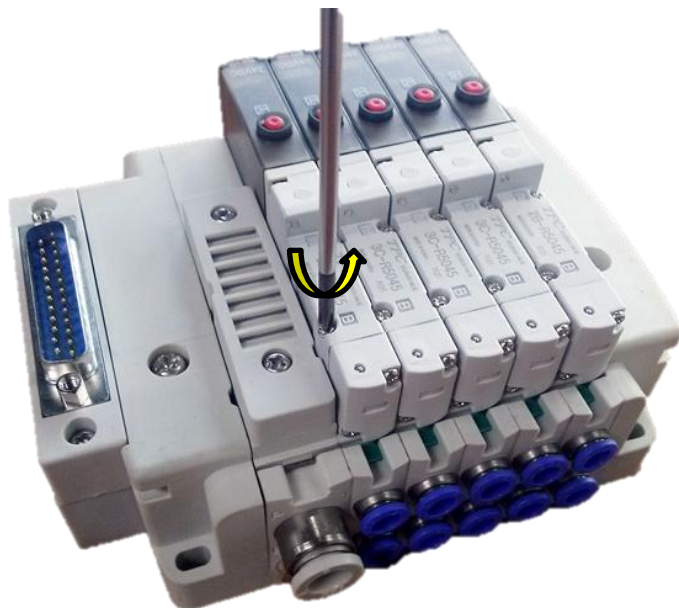

- Second, please lift the valve which should be replaced.

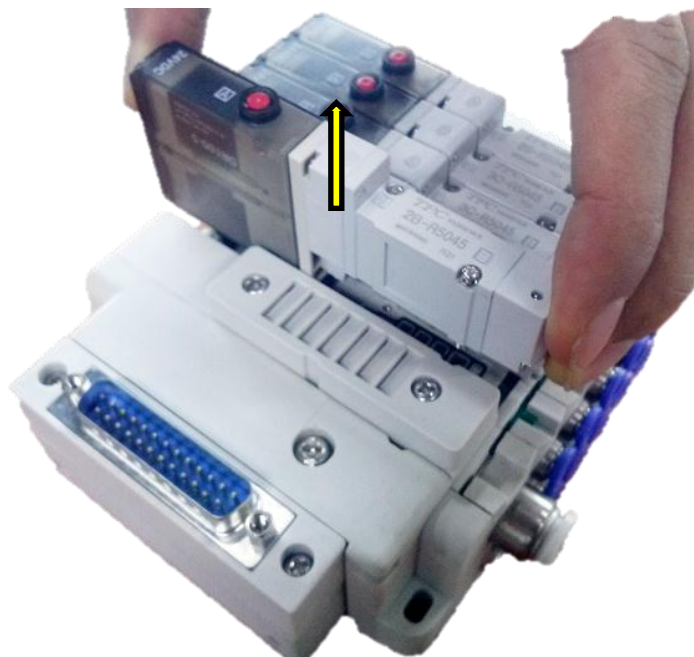

- Caution for Disassembly & Assembly of Valve

⇒ Valves are supplied as assembled units. These units pass a variety of strict quality tests. Once the valve is disassembled, it cannot be guaranteed under the warranty guidelines. If the customer or 'end user' disassembles the valves on their own, the warranty can become void, even though the warranty period is not expired.



How to Re-assemble Valve

- Please re-assemble the valve in reverse order of disassembling. (Please put the valve at the corner of the base correctly)



VIEW A

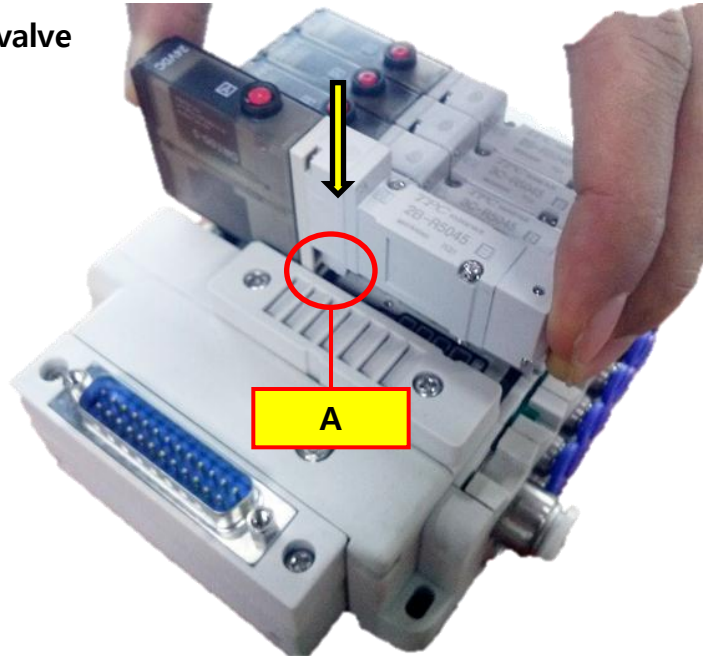

- After putting a valve on the base, please fix it by fastening 2 screws. Then, in order to make sure the valve works properly, supply electricity, and test the valve.

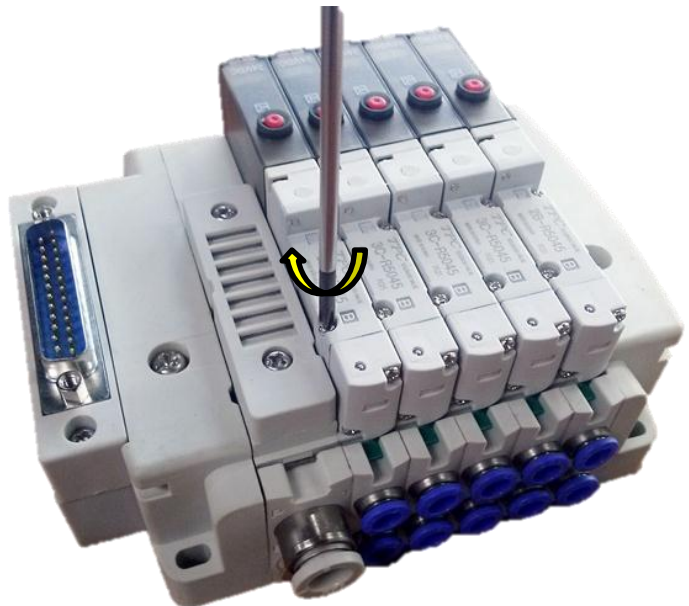

■ Caution for Disassembly & Assembly of Valve

⇒ Valves are supplied as assembled units. These units pass a variety of strict quality tests. Once the valve is disassembled, it cannot be guaranteed under the warranty guidelines. If the customer or 'end user' disassembles the valves on their own, the warranty can become void, even though the warranty period is not expired.

How to Disassemble and Re-assemble

■ How to change fittings for main air supply



Caution

⇒ If the fitting lock pin is not hooked firmly, it could cause an accident when the air is supplied.

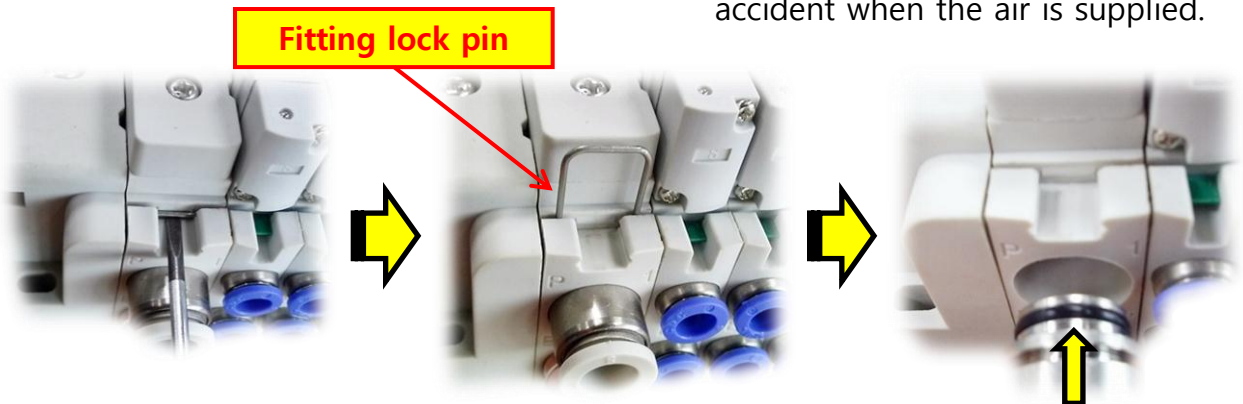

1) Put a slotted screwdriver into the gap of a fitting lock pin.

2) Lift the fitting lock pin. Then, the fitting can be removed.

3) After removing old fitting, replace it with a new one.

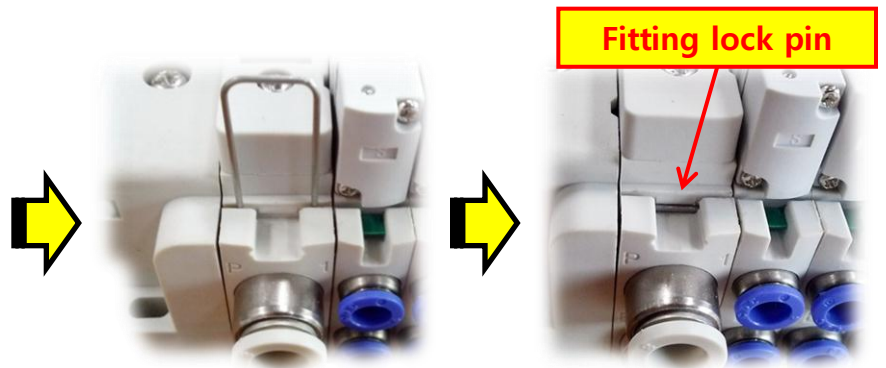

4) Push the fitting lock pin down.

5) Make sure that the fitting lock pin is hooked firmly in place.

■ Caution for Disassembly & Assembly of Valve

⇒ Valves are supplied as assembled units. These units pass a variety of strict quality tests. Once the valve is disassembled, it cannot be guaranteed under the warranty guidelines. If the customer or 'end user' disassembles the valves on their own, the warranty can become void, even though the warranty period is not expired.

How to Disassemble and Re-assemble

■ How to change fittings for air supply To cylinders



Caution

⇒ If the fitting lock pin is not hooked firmly, it could cause an accident when the air is supplied.

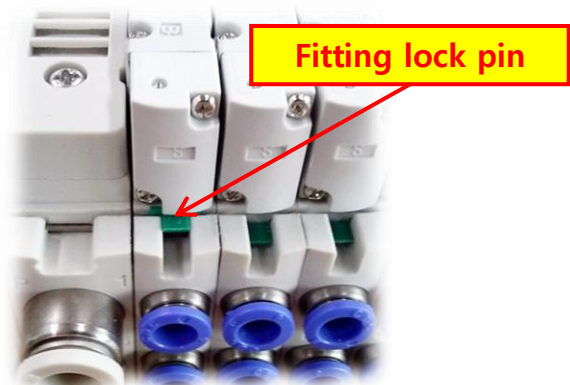

1) Put a slotted screwdriver into the gap of the fitting lock pin.

2) Lift a fitting lock pin. Then, a fitting can be removed.



3) After removing old fitting, replace the fitting with a new one.



4) Make sure that the fitting lock pin is hooked firmly.

■ Caution for Disassembly & Assembly of Valve

⇒ Valves are supplied as assembled units. These units pass a variety of strict quality tests. Once the valve is disassembled, it cannot be guaranteed under the warranty guidelines. If the customer or 'end user' disassembles the valves on their own, the warranty can become void, even though the warranty period is not expired.

How to Disassemble and Re-assemble

■ How to replace side cover, base, and sup/exh block



Caution

⇒ If the block fastener is not fixed firmly, it could cause an accident when the air is supplied.

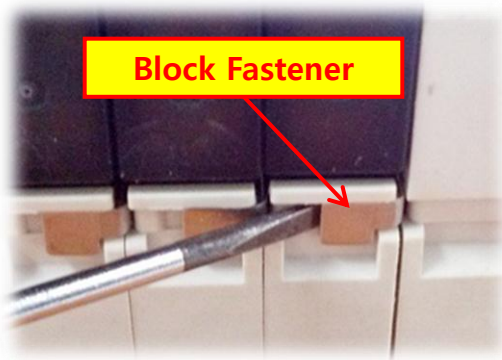

1) Put a slotted screwdriver into the gap of block fastener.



2) Lift a block fastener. Then, a fitting can be removed.

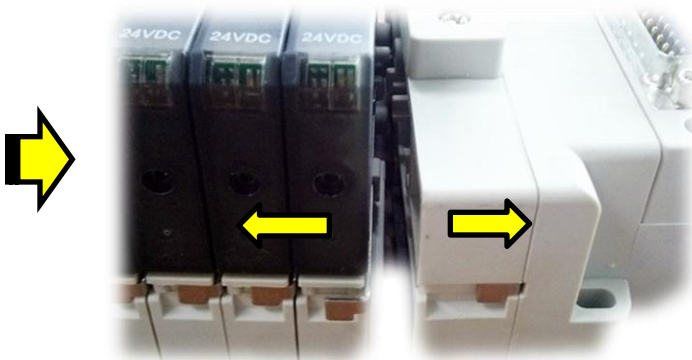

3) After removing a part that should be replaced, replace it with a new one.



4) Make sure that the block fastener is fixed firmly.

■ Caution for Disassembly & Assembly of Valve

⇒ Valves are supplied as assembled units. These units pass a variety of strict quality tests. Once the valve is disassembled, it cannot be guaranteed under the warranty guidelines. If the customer or 'end user' disassembles the valves on their own, the warranty can become void, even though the warranty period is not expired.



Improved PCB of RS1000 series

■ Please choose (+) or (-) common for RS1000 series

D-Sub Connector Type

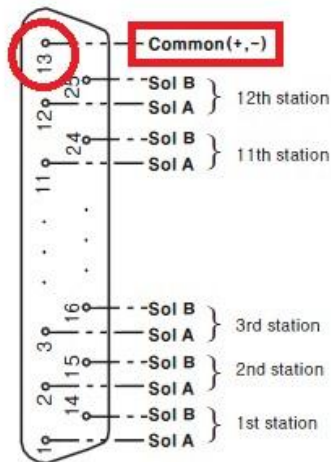

Flat Cable Connector Type

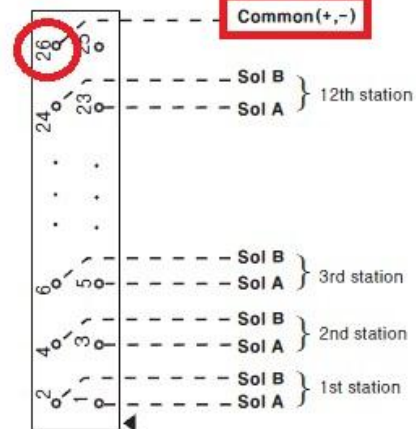

► Changes in Function

- RS1000 valve PCB specification changes from normal non-polar 0.85W to polarity 0.45W(power saving)

► Changes in Order Format

- Valve order format
- Valve & base order format

► Notice

- In case of new power-saving PCB(0.45W), coil specification is separated to(+)common, and (-)common, so it should be specified in part number. In case a customer needs non-polar type valve, please contact our sales office.